

PCI Stainless Steel Conveyor Pulleys

How do you know when to use a stainless steel conveyor pulley?

How should it be constructed?

What are the finish requirements for the application?

Selecting the right component for your particular application is essential for the success of a conveyor design. To meet the requirements of a wide variety of applications, PCI has designed three classes of stainless steel conveyor pulleys. Stainless steel components are used for many reasons, but primarily corrosion resistance, chemical resistance and sanitary applications. The three

classes of stainless steel pulleys vary in construction and surface finish specifications. Using the following selection guide will help you determine the most economical and appropriate pulley design for your specific application. For more information contact a PCI sales engineer or check out our web site at www.pcimfg.com.

Pulleys can be demagnetized for an additional cost. For more details, or to discuss your specific requirements, please contact a PCI Sales Engineer.

Class I

- Sanitary class
- Designed for direct food contact zone applications
- Flush-end plate construction
- Fabricated from 304 stainless steel
- All surfaces have a finish of 32 RA or better
- Available in diameters of 2" - 8"
- Lengths up to 48" - maximum lengths depend on diameter selected
- Available in Type 1 hub construction only
- Can be supplied with vulcanized food grade lagging

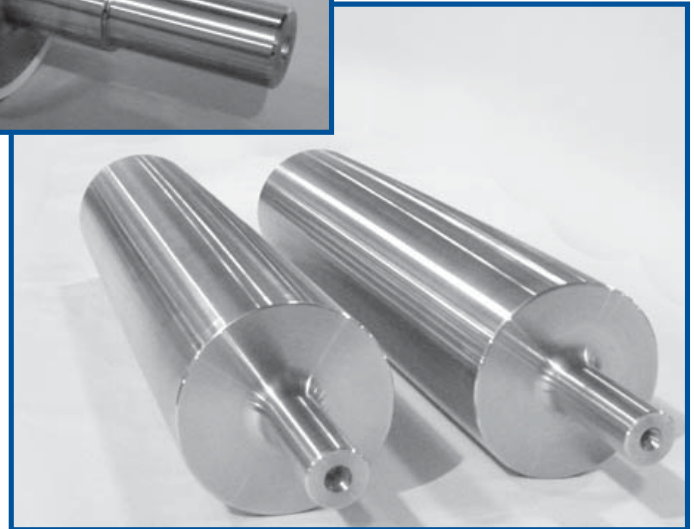
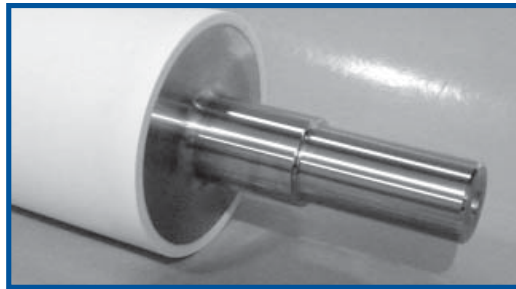

Manufactured to strict finish requirements on all surfaces (32 RA or better) including weld fillets, there are no imperfections on any of the surfaces for bacteria to collect. This class of pulleys was designed to be used in food industry applications where FDA and USDA

requirements for sanitary components are the most stringent. Available in standard type-1 (welded axle) construction only. The construction and finish tolerances of this class of pulley make it the most expensive of the classes.

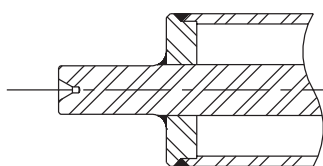

TYPE-1
Fixed Bore Plates
with Axle (Axle is Required)
All Surfaces 32 RA or Better
Center Drill Both Ends Standard

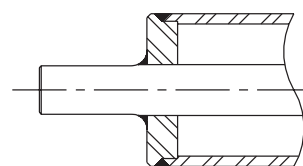

TYPE-1
Fixed Bore Plates
with Axle (Axle is Required)
All Surfaces 32 RA or Better
Center Drill Can be Removed for an
Additional Charge

PRO CAL INC.
P.O. Box 115
Alpena, MI 49707-0115

Toll Free 800-323-0966

www.pcimfg.com

e-mail: sales@pcimfg.com or drawings@pcimfg.com

Class II

- Washdown/corrosion resistant class
- Designed for non-food contact zone washdown applications
- Flush-end plate construction
- Fabricated from 304 stainless steel
- Standard mill finish, media treated on all surfaces
- Welds are ground and media treated
- Available in Type 1, Type 2 and Type 3 hub styles
- Can be supplied with stainless steel or carbon steel bearings. Please specify when ordering.
- Available in a wide variety of vulcanized rubber compounds

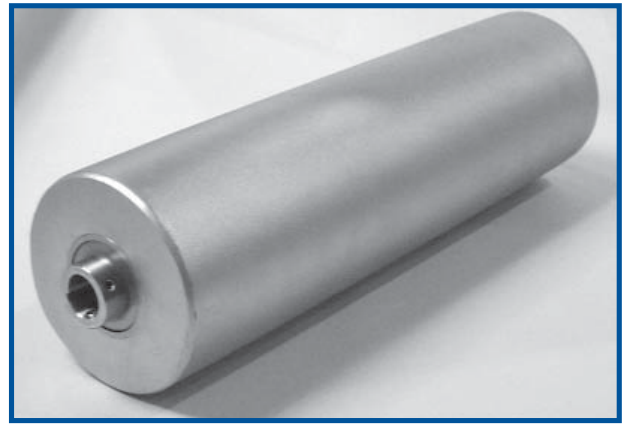

Finish requirements are less stringent in this class making it less expensive than Class-1 construction. All welds are ground, and all surfaces are media treated for a consistent finish appearance. Surfaces may have slight imperfections, including pits, scratches, and small pockets. Flush end-

plate construction minimizes the possibility of material build-up. Designed for use on conveyors where sanitary requirements are less stringent, or where product is already packaged. Available in most standard hub styles. Diameters 2" - 12".

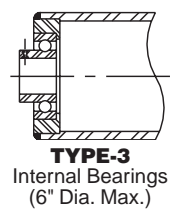
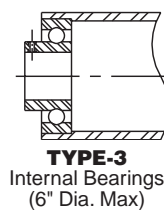
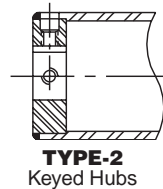
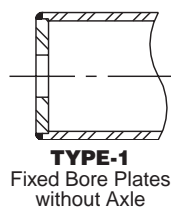
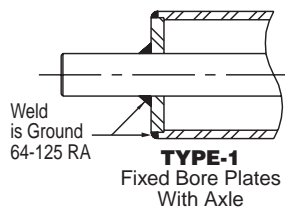

Class III

- Washdown/corrosion resistant class
- Used in applications where corrosion resistance is required
- Recessed end-plate construction
- Fabricated from 304 stainless steel
- Standard mill finish, media treated on all surfaces
- Welds are in "as welded" condition
- Available in Type 1, Type 2, Type 3 or compression hub styles
- Can be supplied with stainless steel or carbon steel bearings. Please specify when ordering.
- Available in a wide variety of vulcanized rubber compounds

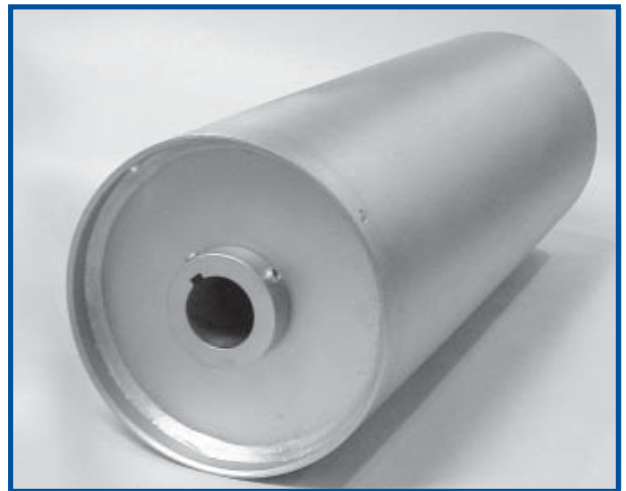

Finish requirements are similar to the Class-2 construction, except welds are not ground and end-plates are not flush with the end of the pulley. All surfaces are media treated for a consistent finish appearance. Surfaces may have slight imperfections, including pits, scratches, and small pockets. Designed for conveyor

applications where sanitary requirements are not a concern. Ideal for applications that require a corrosion resistant pulley made from stainless steel. Class-3 pulleys are the least expensive of the stainless steel pulley offerings from PCI. Available in all standard hub styles. Diameters 2" - 12".

